

data sheet

50GB/50GB-A series

CSA and UL listed gas shut-off valve



features

- for natural gas, manufactured and mixed gas, liquefied petroleum gases and LP gas-air mixtures
- rated pressures of ½, 2 and 5 psig
- standard connection is FNPT x FNPT
- high BTU capacity
- reversible plated steel lever handle
- manufactured in the USA - BABA and BAA compliant

description

The “Apollo”® 50GB/50GB-A series is designed for “main burner” applications with cast-in dual pilot tap. ASTM B584 bronze body, stainless steel ball, brass stem, retainer and gland screws for corrosion resistance. Double side taps for pilot light or pressure gauge connections. Proudly manufactured in our South Carolina facilities.

size range

- ¼” - 2”

connections

- threaded

configurations

- 50-GB series - standard

approvals

- CGA 9.1 (5 psig)
- ASME B16.44 (2 and 5 psig)
- ANSI Z21.15/CSA 9.1 (½ psig)
- UL 125 - flow control valves for LP-gas, guide YSDT to 250 psig max
- UL 842 - valves for flammable fluids, guides YRBX, YRPV, and MHKZ to 250 psig max
- Buy American Act (BAA)
- Build America Buy America (BABA) Act



this specification is provided for reference only. we reserve the right to change any portion of this specification without notice and without incurring obligation to make such changes to Aalberts integrated piping systems products previously or subsequently sold.

Aalberts integrated piping systems

10715 Sikes Place / suite 200 / Charlotte / NC / 28277
aalberts-ips.us

component	material
body	bronze, ASTM B584
retainer	brass, ASTM B16
ball	stainless steel, ASTM A276-316
seat	PTFE
stem/gland	brass, ASTM B16
stem packing	RPTFE
handle/nut	steel, zinc plated, plastisol grip

performance rating	
CWP	temperature
½ - 5 psig	32°F - 125°F

job name	
job location	
engineer	
contractor	
tag	
PO#	
rep	
wholesaler dist	

data sheet

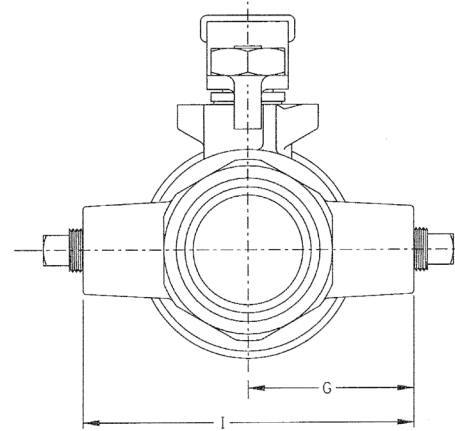
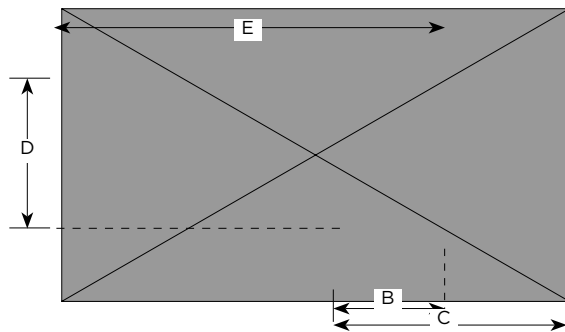
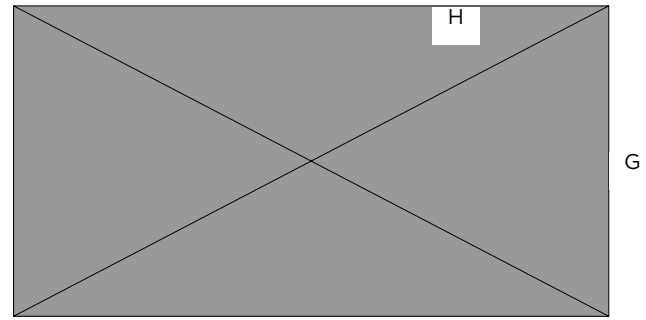
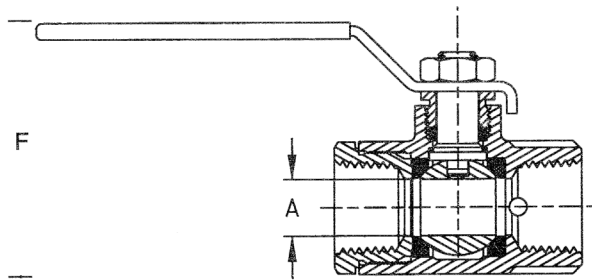

dimensions

50GB

model number single tapped	number double tapped	size	tapping	a	b	c	d	e	f	g	h	i	BTU/HR*
50GB-301	--	½"	¼"	0.50"	1.11"	2.25"	1.68"	3.85"	2.27"	1.00"	0.53"	--	693,000
--	50GB-401A	¾"	¼"	0.75"	1.26"	2.67"	1.93"	3.85"	2.72"	1.12"	0.75"	2.24"	1,258,000
--	50GB-501A	1"	¼"	1.00"	1.65"	3.42"	2.19"	4.78"	3.18"	1.53"	0.94"	3.06"	3,144,000
--	50GB-601A	1 ¼"	¼"	1.25"	1.87"	3.86"	2.37"	4.78"	5.36"	1.62"	1.15"	3.24"	6,441,000
--	50GB-701A	1 ½"	¼"	1.50"	2.05"	4.22"	2.81"	5.40"	4.21"	1.81"	1.31"	3.62"	7,745,000
--	50GB-801A	2"	¼"	2.00"	2.48"	5.02"	3.18"	5.40"	4.93"	2.18"	1.68"	4.36"	14,741,000

50GB-A

model number single tapped	number double tapped	size	tapping	a	b	c	d	e	f	g	h	i	BTU/HR*
--	50GB-5A1A	1"	¼"	1.00"	1.65"	3.42"	2.19"	4.78"	3.18"	1.53"	0.94"	3.06"	3,144,000
--	50GB-6A1A	1 ¼"	¼"	1.25"	1.87"	3.86"	2.37"	4.78"	5.36"	1.62"	1.15"	3.24"	6,441,000
--	50GB-7A1A	1 ½"	¼"	1.50"	2.05"	4.22"	2.81"	5.40"	4.21"	1.81"	1.31"	3.62"	7,745,000
--	50GB-8A1A	2"	¼"	2.00"	2.48"	5.02"	3.18"	5.40"	4.93"	2.18"	1.68"	4.36"	14,741,000

*capacity based on a gas having a heating value of 1000 BTU/cubic feet and an S.G. of 0.64 at a P.D. of 1" W.C.

options

option	component	size
(-01)	standard	all
(-07)	tee handle	all
	¼" side tap - standard	all